



ENGINEERING EXCELLENCE

Americana Series #2AM600

PARTS BREAKDOWN SHEET

DESCRIPTION

- Wall Mount Pot Filler
- Metal Lever Handles
- Space Saving Swivel Spout
Folds in When Not in Use
- 21-7/8" Spout Reach
- Ceramic Disc Cartridges
- 1-Hole Wall Mount Installation
- Designed for Cold Water
- 1/2" IPS Connection with
flange

FINISHES

- PC PVD Polished Chrome
- BN PVD Brushed Nickel
- SS PVD Stainless Steel
- PN PVD Polished Nickel
- PB PVD Polished Brass
- GR PVD Golden Rose
- ORB Oil Rubbed Bronze
- TB PVD Tuscany Bronze

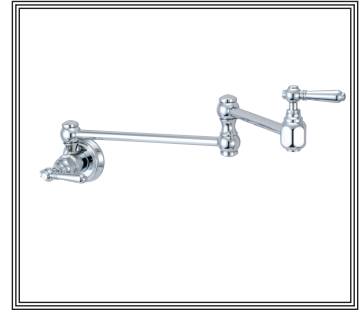

#2AM600 SHOWN * ADA 

STANDARDS APPLICABLE

- ASME A112.18.1
- ANSI A117.1
- ANSI / NSF 61, SECTION 9
- CUPC / IAPMO LISTED / ADA
COMPLIANT
- CONTAINS NO MORE THAN
0.25% WEIGHTED AVERAGE
LEAD CONTENT

FLOW

- Aerator Limited to 2.0 GPM

Model #: _____

Specific Features: _____

Project Name: _____

Submitted For: _____

Model	Description	Finishes
#2AM600	Wall Mount Pot Filler	<input type="checkbox"/> PC <input type="checkbox"/> Other _____



ENGINEERING EXCELLENCE

Pioneer:1-800-338-9468

Commerce, CA 90040

www.pioneerind.com

Pioneer Industries, Inc. © 2013

DMPB2AM600/REV. 12 2012

Page 1 of 2

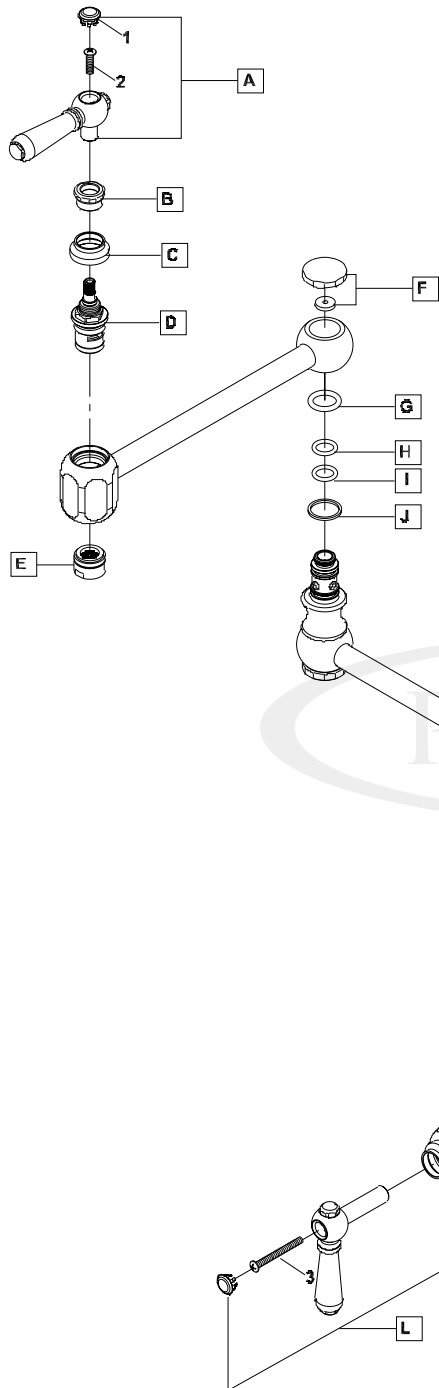

	ITEM#	DESCRIPTION
A	X-1200010*	Lever Handle
B	X-4200093*	Handle Sleeve
C	X-4200067*	Handle Escutcheon
D	X-3200004H	Ceramic Cartridge
E	X-4900041*	2.0 GPM Aerator
F	X-4200094*	Spout Cap & Washer
G	X-4200095	O-Ring
H	X-4200096	O-Ring
I	X-4200097	O-Ring
J	X-4200098	Gasket
K	X-4200099	O-Ring
L	X-1200009*	Americana Lever Handle
M	X-3200004H	Ceramic Cartridge
N	X-4200064*	Escutcheon
O	X-5200010	Mounting Kit
P	X-4900040	Allen Wrench
Q	X-4900024	Allen Wrench
1	X-4900042P*	Handle Button-Plain
2	X-4900043	Handle Screw
3	X-4200065	Handle Screw
4	X-4900039	Allen Screw
5	X-4900002	Allen Screw

* Note- Please specify finish/color code while ordering.

Product Diagram



ENGINEERING EXCELLENCE

Pioneer: 1-800-338-9468
 Commerce, CA 90040
 www.pioneerind.com
 Pioneer Industries, Inc. © 2013